

Vista FRONTE

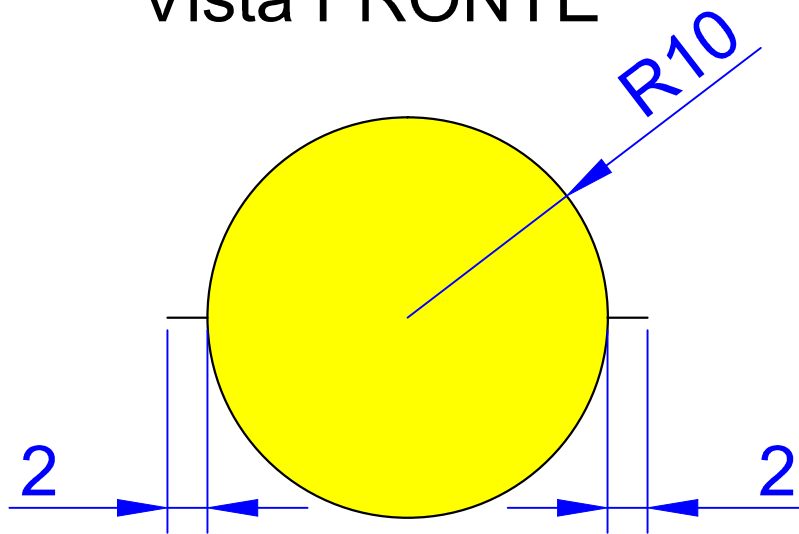

1

Prof. Pisani Antonio

Vista ALTO

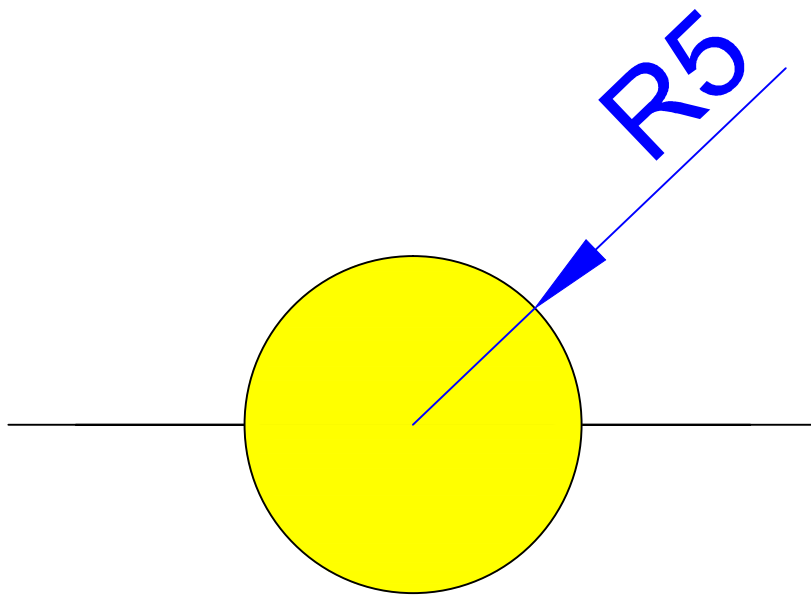

2

Prof. Pisani Antonio

Vista FRONTE

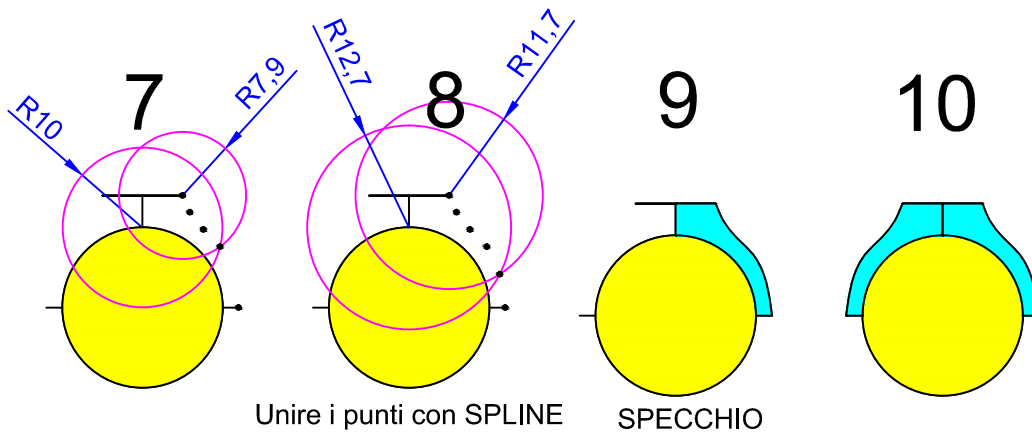
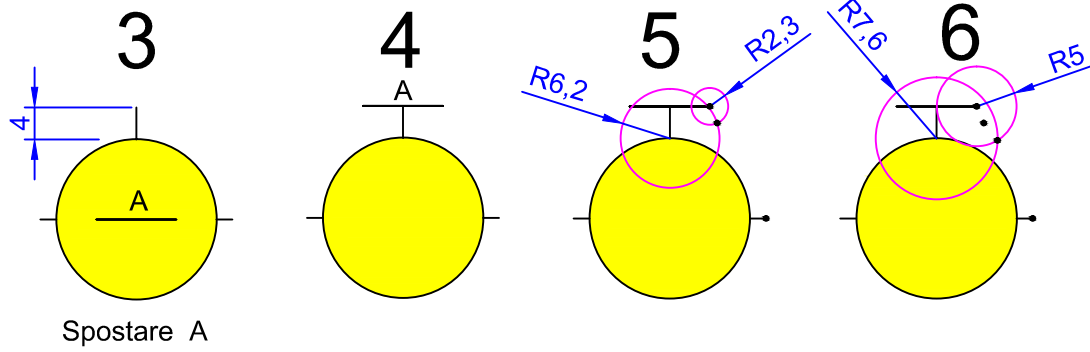

Vista ALTO

11

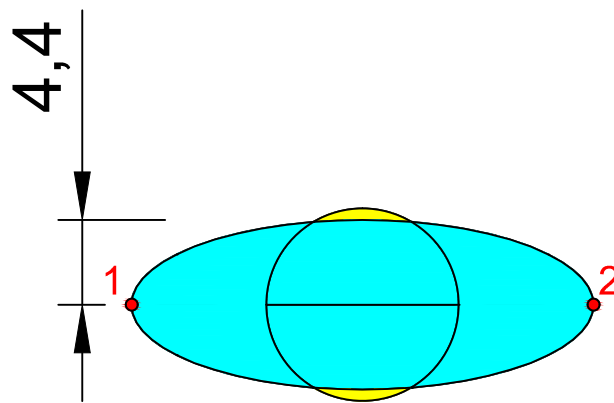

ELLISSE

Prof. Pisani Antonio

Vista SINISTRA

12

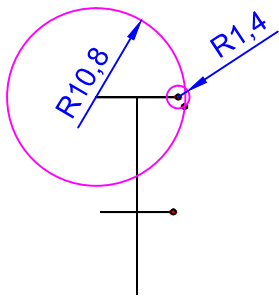

13

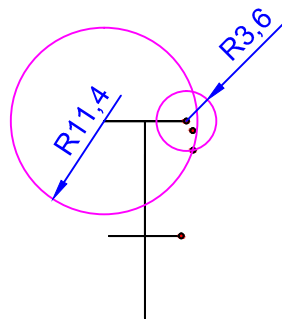

14

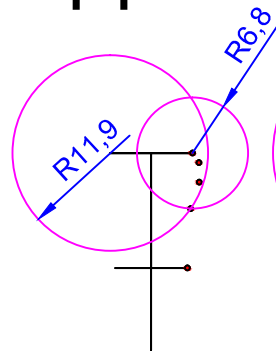

15

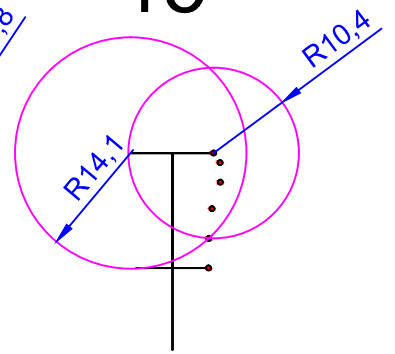

16

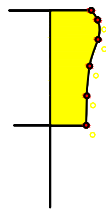

UNIRE I PUNTI CON SPLINE

17

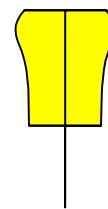

SPECCHIO

Vista SUD-EST

18

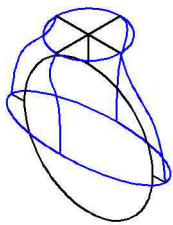

LOFT- Guida



Risultato 18

19

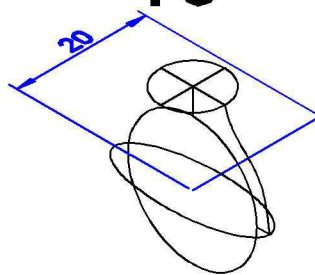

Linea - disegnare
altro cerchio

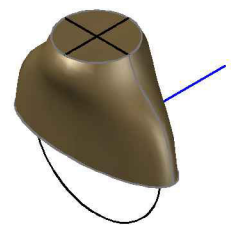

Risultato 19

20

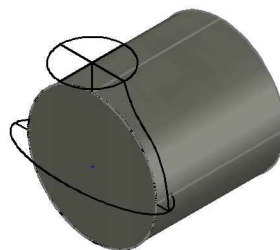

ESTRUDI 20



Risultato 20

21

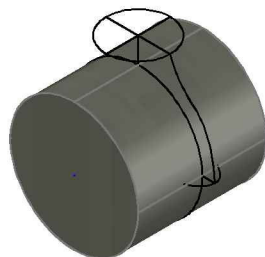

Spostare il cilindro al
centro del cerchio

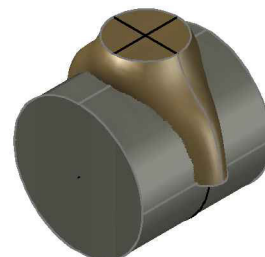

Risultato 21

Vista SUD-EST

22

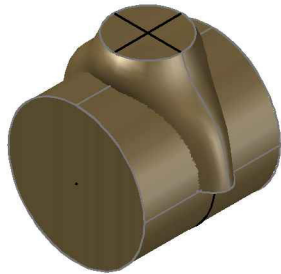

SOTTRAI il cilindro

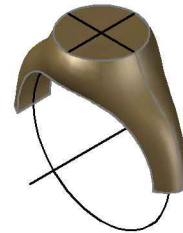

Risultato 22

23

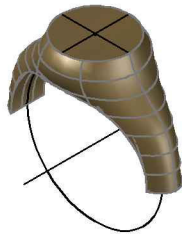

Copiare 22 -ESPLODI - Eliminare le parti che non interessano



Risultato 23

24

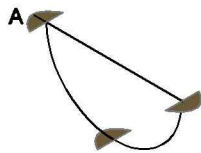

Copiare A

25

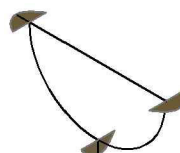

Ruotare in 3D di 90° attorno l' asse Y

26

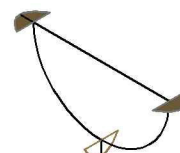

Modificare l'arco

27



LINEA 1

28



Arco 3 Punti

29

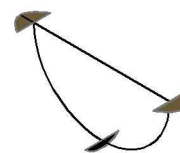

REGIONE

Vista SUD-EST

30

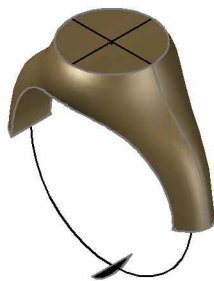

Comando LOFT



Risultato 30

31

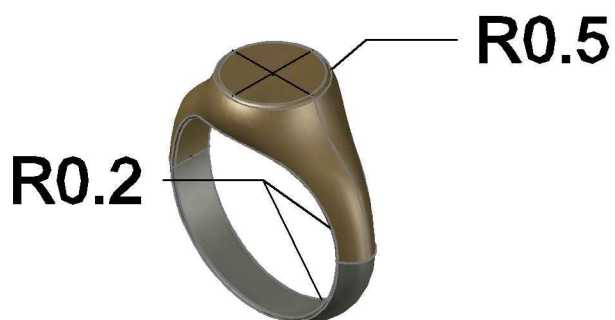

Raccordare R0.2 - R0.5

Vista dall' ALTO

32

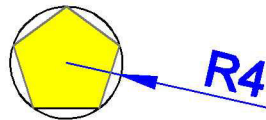

CERCHIO - POLIGONO 5 LATI

33

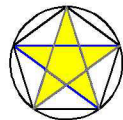

LINEE

34



Regione, unire e colorare a piacimento

Prof. Pisani Antonio

Vista SUD-EST

35



Spostare sull' anello

36



Colorare l' anello a piacimento

Prof. Pisani Antonio



Prof. Pisani Antonio